



**Assembly Instructions**

**ASGARD  
'FREESTORE'  
PACK CONTENTS**

ITEM NO	PART DESCRIPTION	QTY
1	44294 TOP PNL 1570mm*1107mm	1
2	44158 LH BACK PNL 1979*760	1
3	44159 RH BACK PNL 1979*777	1
4	44295 SIDE PNL 1834*1067	2
5	44164 LH FRONT PNL 1862*385	1
6	44376 RH FRONT PNL 1862*385	1
7	44298 BASE PNL 1056*1518	1
8	44167 FASCIA PNL 787*220	1
9	44374 DOOR ASSEMBLY 1733*780	1
10	ZSCREW/61 Not 10*5/8 S/TAPP	135
11	ZSCREW/340 M5*12 CSK S7/ST	9
12	ZSCREW/32 M7 5*60 ANCHOR BOLT	4
13	ZCOMP/AS22 23 24 2mm,3mm,5mm PACKERS	2 EA
14	SEALANT	1

# SELF ASSEMBLY INSTRUCTIONS

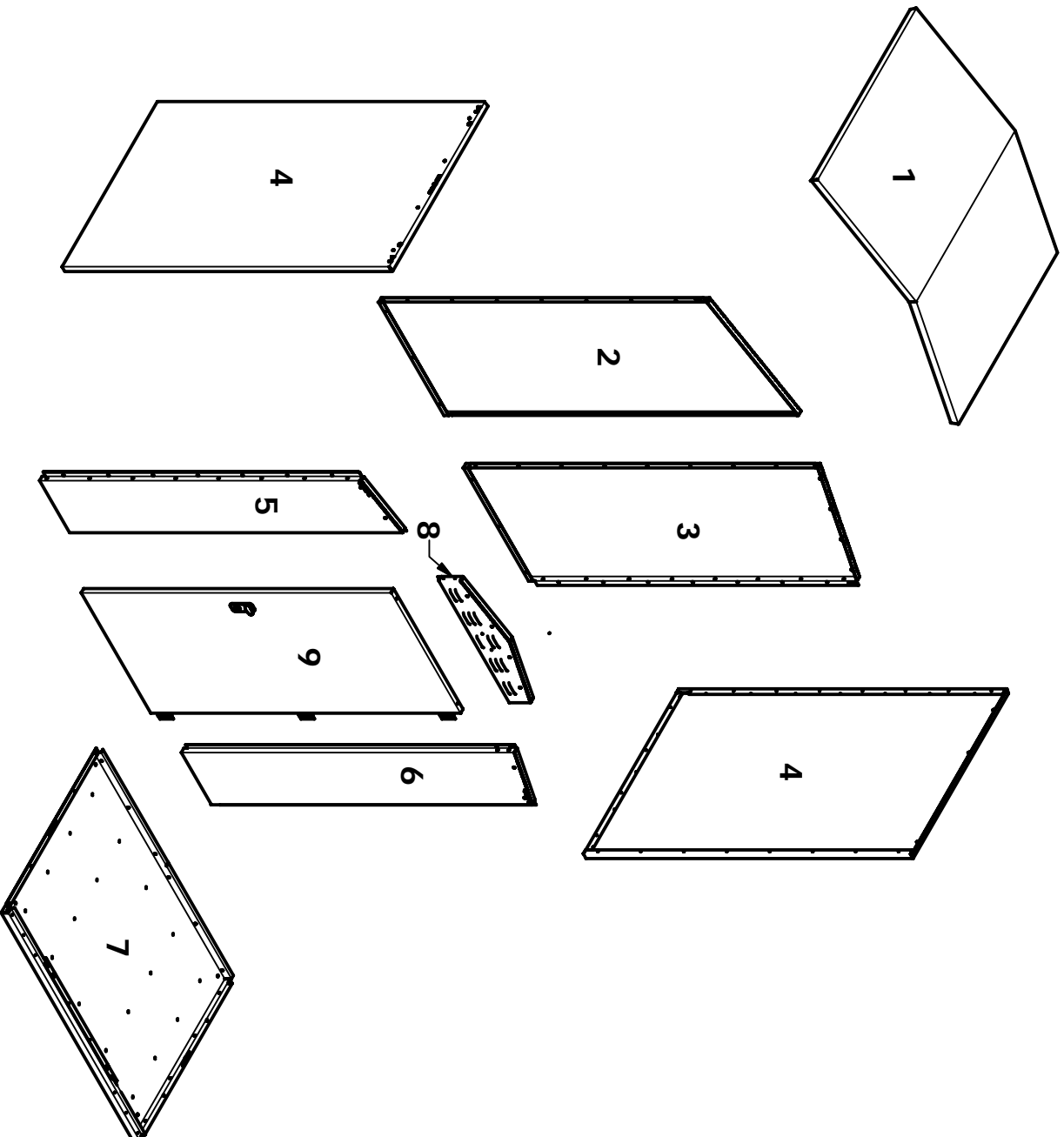

15	ZCOMP/LAS02 SELF SEAL PLUG	4
----	----------------------------------	---

## ASGARD ASGFS1511###

PLEASE NOTE FOR SAFETY REASONS THE ASSEMBLY OF THIS UNIT **REQUIRES TWO PEOPLE.**

### BASE INSTRUCTIONS

A FIRM, LEVEL, FLAT SURFACE IS REQUIRED AS A BASE FOR THIS UNIT SUCH AS CONCRETE OR FLAGS.

**- MINIMUM BASE MEASUREMENT (ALLOWS FOR RAMP) 1730W\*1557D)**

### TOOLS REQUIRED

- POSI-DRIV SCREWDRIVER  
(POWER DRIVER RECOMMENDED)

- 6mm DIA MASONRY DRILL  
- 13mm SOCKET SPANNER  
(FOR ANCHOR FIXINGS)

- A TUBE OF ALL WEATHER SEALANT SUITABLE FOR STEEL AND CONCRETE.

### DOOR ALIGNMENT & ANCHORING

#### OF UNIT

IT IS IMPORTANT TO CORRECTLY LEVEL THE UNIT USING THE PACKING PIECES PROVIDED, ONCE ASSEMBLY IN ACCORDANCE WITH THE INSTRUCTIONS OVERLEAF IS COMPLETE AND PRIOR TO FIXING THE UNIT TO THE GROUND.

- SLIDE THE PACKING PIECES UNDER THE CORNERS OF THE UNITS BASE AS REQUIRED UNTIL AN EQUAL GAP HAS BEEN ACHIEVED AROUND THE DOORS ALLOWING FOR THEIR SMOOTH OPERATION & ALIGNMENT.

- DRILL THROUGH THE FOUR HOLES IN THE BASE OF THE UNIT USING 6mm DIA MASONRY DRILL TO A DEPTH OF 70mm.

- SCREW IN THE ANCHOR FIXINGS. (THESE HAVE A SELF CUTTING THREAD)

**IF NOT ANCHORING THE UNIT USE THE SELF SEAL PLUGS TO BLOCK THE FIXING HOLES (FIT FROM UNDERSIDE)**

**IF FITTING THE OPTIONAL RAMP IT IS ADVISED THAT THIS IS POSITIONED PRIOR TO BUILDING THE UNIT.**

PLEASE SEE OUR WEBSITE FOR DETAILS OF MAINTENANCE OF THIS PRODUCT  
WWW.ASGARDSS.CO.UK **0443771**

**STEP 1**

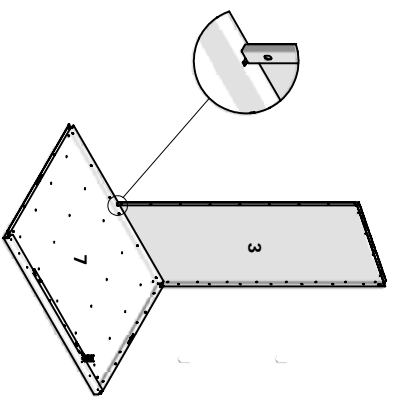

PARTS	INSTRUCTION
<p><b>BASE</b> - 7</p> <p><b>RH BACK</b> - 3</p>	<p>POSITION BASE PANEL '7' &amp; RH BACK '3' AS SHOWN LOCATING THE CENTRE FLANGE ON THE BACK IN THE SLOT ON THE REAR OF THE BASE PANEL. ENSURE HOLES ARE ALIGNED AND SCREW TOGETHER.</p> <p><b>(THE BACK WILL REQUIRE SUPPORTING UNTIL THE SIDE PANEL AS BEEN ATTACHED)</b></p>
<p>3*</p>	

**STEP 2**

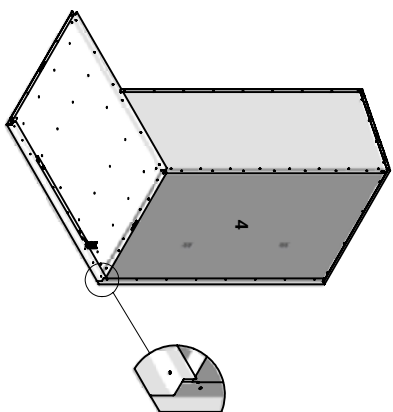

PARTS	INSTRUCTION
<p><b>SIDE PANEL</b> - 4</p>	<p>POSITION ONE OF THE SIDE PANELS '4' UP TO THE PRE ASSEMBLED BASE AND BACK ENSURING THAT IT IS FLUSH WITH THE FRONT OF THE BASE PANEL. ALIGN HOLES AND SCREW TOGETHER.</p>
<p>23*</p>	

**STEP 3**

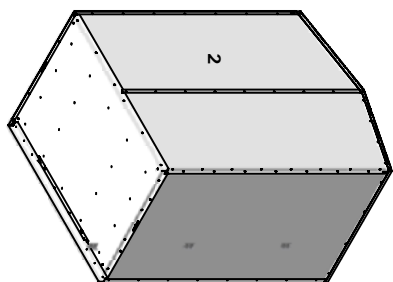

PARTS	INSTRUCTION
<p><b>LH BACK</b> - 2</p>	<p>LOCATE LH BACK PANEL '2' INTO THE BASE &amp; RH BACK AS SHOWN ENSURING THAT THE CORNER JOINT IS CORRECTLY ALIGNED ALONG WITH THE FLANGING HOLES.</p> <p>SCREW TOGETHER ALONG THE BASE AND VERTICAL JOINT.</p>
<p>19*</p>	

**STEP 4**

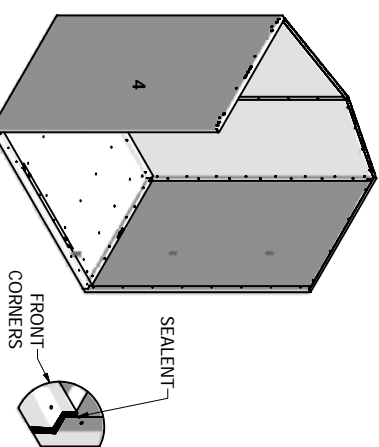

PARTS	INSTRUCTION
<p><b>SIDE PANEL</b> - 4</p> <p><b>SEALANT</b></p>	<p>LOCATE 2ND SIDE PANEL '4' INTO THE BASE &amp; LH BACK AS SHOWN ENSURING THAT IT IS FLUSH WITH THE FRONT OF THE BASE.</p> <p>SCREW TOGETHER ALONG THE BASE AND VERTICAL JOINTS.</p> <p><b>IMPORTANT</b> PRIOR TO FITTING FRONT PANELS (STEP 5) APPLY A BEAD OF SEALANT ALONG THE FRONT CORNERS AS INDICATED.</p>
<p>22*</p>	

**STEP 5**

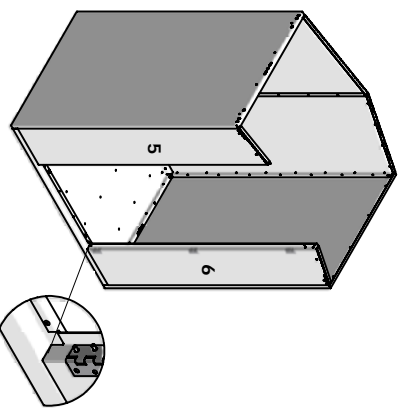

PARTS	INSTRUCTION
<p><b>LH FRONT PANEL</b> - 5</p> <p><b>RH FRONT PANEL</b> - 6</p>	<p>POSITION RH FRONT PANEL '6' ON TO THE FRONT OF THE BASE AS SHOWN. SLIDE THE PANEL UP TO THE SIDE PANEL SO THAT THE INNER FIXING FLANGE LOCATES AROUND THE FOLDS ON THE SIDE.</p> <p>ENSURE THE HOLES ARE ALIGNED AND SCREW TOGETHER THIS SHOULD SQUEEZE THE APPLIED BEAD OF SEALANT INTO THE CORNER JOINT TO SEAL.</p>
<p>36*</p>	<p>REPEAT THIS WITH LH FRONT PANEL '5'.</p>

**STEP 6**

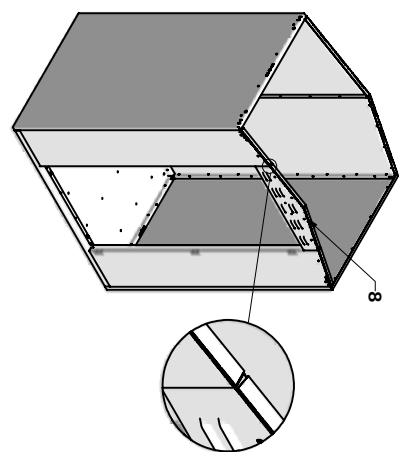

PARTS	INSTRUCTION
<p><b>FASCIA PANEL</b> - 8</p>	<p>ATTACH FASCIA PANEL '8' TO LEFT AND RIGHT HAND FRONT PANELS AS SHOWN. POSITION IT SO THAT IT RUNS IN LINE WITH THE TOP OF THE FRONT PANELS.</p> <p>ALIGN HOLES AND SCREW TOGETHER</p>
<p>8*</p>	

**STEP 7**

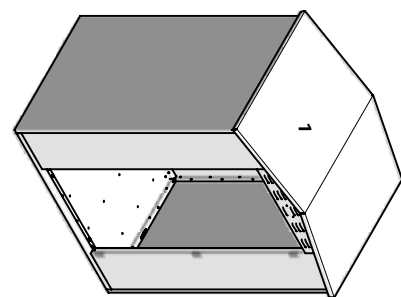

PARTS	INSTRUCTION
<p><b>ROOF PANEL</b> - 1</p>	<p>LIFT ROOF PANEL '1' ONTO THE ASSEMBLED PARTS. SCREW TOGETHER.</p>
<p>24*</p>	

**STEP 8**

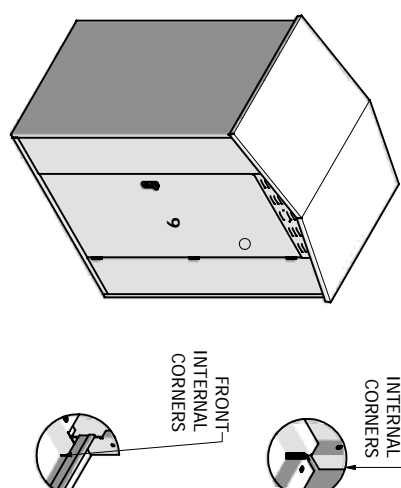

PARTS	INSTRUCTION
<p><b>DOOR</b> - 9</p> <p><b>SEALANT</b></p>	<p>WE RECOMMEND THAT YOU USE HAND HELD DRIVERS RATHER THAN POWER DRIVERS WHEN FIXING THE DOOR. IT IS IMPORTANT TO SUPPORT THE DOOR AT ALL TIMES WHEN FITTING THE SCREWS TO ENSURE CORRECT ALIGNMENT AND SO NOT TO DAMAGE THE THREADED INSERTS.</p> <p>ALIGN THE HINGES OF DOOR '9' AND SCREW IN POSITION. SEE PAGE 7 WITH REFERENCE TO CORRECT DOOR ALIGNMENT AND LEVELLING PROCEDURE.</p> <p>HAVING LEVELLED THE UNIT, USE THE SEALANT TO SEAL ALL FOUR INTERNAL CORNERS OF THE BASE.</p>
<p>9*</p>	