



ASGARD
SECURE STEEL STORAGE

ADDITION

WWW.ASGARDSSS.CO.UK

ASSEMBLY INSTRUCTIONS



ASGARD 'ADDITION'
PACK CONTENTS:

ITEM NO	PART DESCRIPTION	QTY
1	32604 TOP PANEL 1832w x 925h	1
2	36443 BASE PANEL 1782.6w x 871.3D	1
3	36557 LH BACK PANEL 893.0 x 1400h	1
4	36558 RH BACK PANEL 920.0w x 1400h	1
5	36555 LH SIDE PANEL 875w x 1400h	1
6	36556 RH SIDE PANEL 875w x 1400h	1
7	36560 LARGE FRT PANEL 507w x 1303h	1
8	36561 FASCIA 1222.5w x 140h	1
9	32615 RAIN GUARD 1270w x 79.6h	1
10	33867 LH DOOR 635.7w x 1195h	1
11	36935 RH DOOR 603.5w x 1195h	1
12	36934 FRT PNL TRAP PLATE 1268w x 50h	1
13	32670 STOPPER BRKT 31.6w x 15h	12
14	M5-10 COUNTER SINK MACHINE SCREW, (DOOR FIXING SCREWS) ZS0RE040	18
15	NO 10-5/8 POSITIVE SELF TAPPING SCREW, (GARAGE ASSEMBLY) ZS0RE040	130
16	M7.5x60 ANCHOR FIXINGS, ZS0RE032	4
17	PACKING PIECES (FOR LEVELING OF UNIT)	2 at 20mm 2 at 30mm 2 at 5mm
18	SELF SEALING PLUGS Z0MPPLAS102	8

SELF ASSEMBLY INSTRUCTIONS

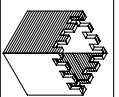
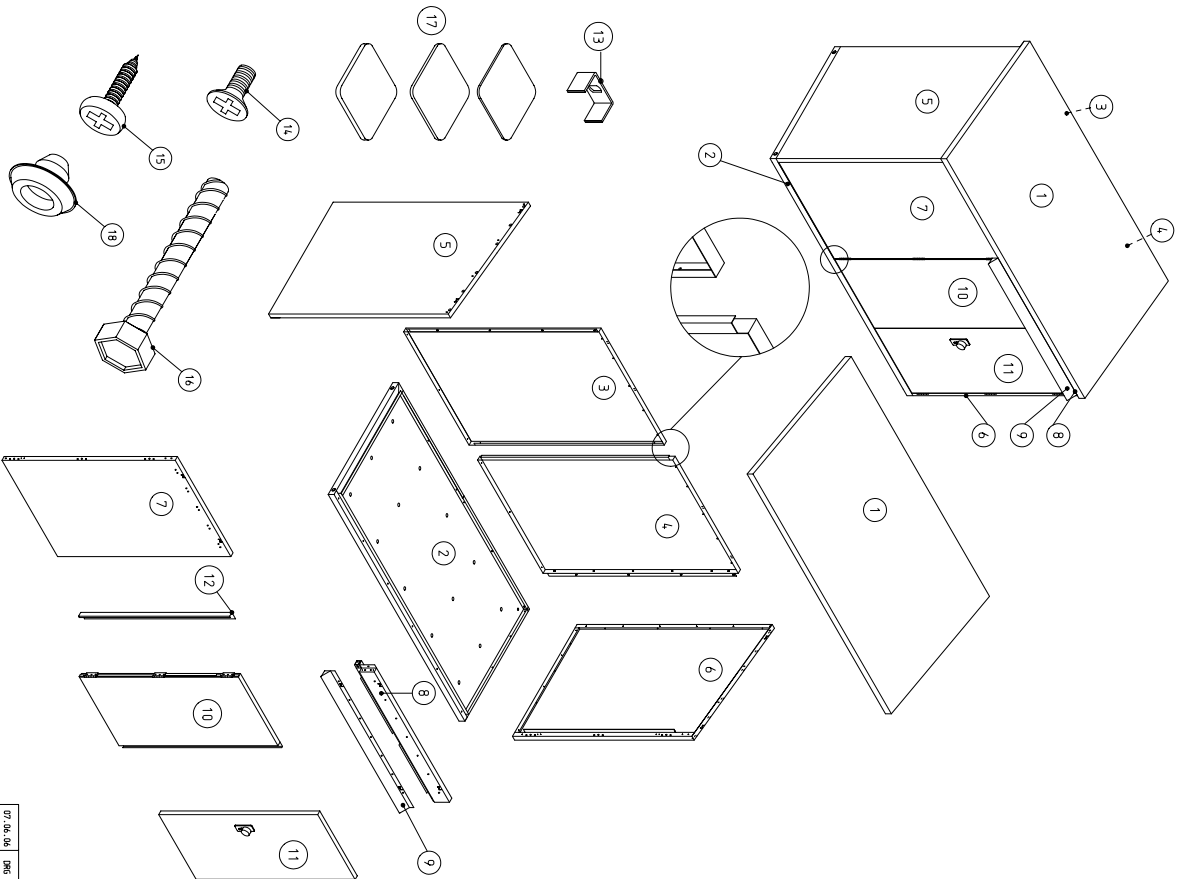

ASGARD

A D D I T I O N

PLEASE NOTE THAT FOR SAFETY REASONS THE ASSEMBLY OF THIS SECURE STORAGE UNIT WILL REQUIRE 2 PEOPLE.

PRIOR TO ASSEMBLY

DECIDE WHICH SIDE YOU WISH TO HANG THE DOORS FROM AS THIS DETERMINES THE POSITION OF FRONT PANEL '7'. (STEP 5 OF THE ASSEMBLY)

BASE INSTRUCTIONS

A LEVEL, FIRM SURFACE IS REQUIRED AS A BASE FOR THE UNITS, (EG. CONCRETE, FLAGS). WE RECOMMEND THE USE OF VIBRATED CAST SLABS. AS THESE WILL GIVE A MORE SECURE FASTENING, WHEN USED IN CONJUNCTION WITH THE 4 ANCHOR SCREWS PROVIDED.

- ANHXXE 1790MM*905MM (70.5"*35.5")
- MINIMUM BASE MEASUREMENT:
- 1990MM*1100MM (78.5"*43.5")

TOOLS REQUIRED

- POZIDRIV SCREWDRIVER AND SLOTTED SCREWDRIVER (POWERDRIVER RECOMMENDED)
- 6MM DIAMETER MASONRY DRILL (FOR ANCHOR FIXINGS).
- 13MM SOCKET SPANNER (FOR ANCHOR FIXINGS)
- SILICONE SEALANT RECOMMENDED

DOOR ALIGNMENT & ANCHORING THE UNIT

IT IS IMPORTANT TO CORRECTLY LEVEL THE UNIT USING THE PACKING PIECES PROVIDED. ONCE ASSEMBLY IN ACCORDANCE WITH THE INSTRUCTIONS OVERLEAF IS COMPLETE AND PRIOR TO FIXING THE UNIT TO THE GROUND.

- SLIDE THE PACKING PIECES UNDER THE CORNERS OF THE UNIT'S BASE AS REQUIRED UNTIL AN EQUAL GAP HAS BEEN ACHIEVED AROUND THE DOORS. (THIS SHOULD GIVE THEIR SMOOTH OPERATION)
- REMOVE THE RUBBER BASE GROMMITS TO EXPOSE THE FIXING HOLES. DRILL THROUGH USING 6MM DIAMETER MASONRY DRILL TO A MINIMUM DEPTH OF 70MM. (THESE HAVE A SELF CUTTING THREAD AND SCREW DIRECTLY INTO THE CONCRETE OR FLAGGED BASE)

PLEASE SEE OUR WEBSITE FOR DETAILS OF MAINTENANCE INSTRUCTIONS FOR THIS PRODUCT - WWW.ASGARDDSS.CO.UK

STEP 1

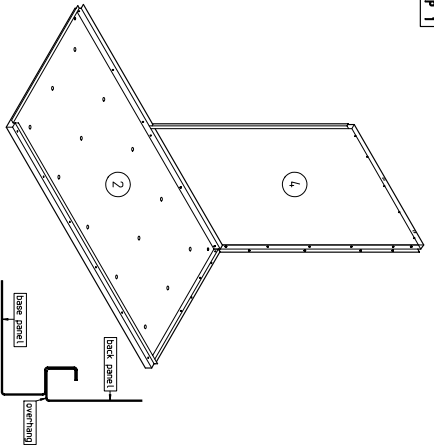

PARTS REQUIRED

- RH BACK PANEL (1)
- BASE PANEL (2)

Position right hand back panel '1' into the channel on the base panel '2' so that fixing holes are aligned, the back panel should slightly overhang the base. Whilst one person holds the panels in place the other should screw the panels together.

5X



STEP 5

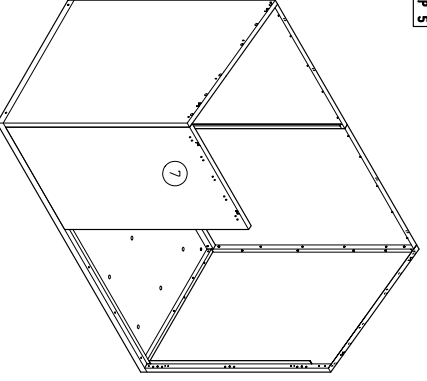

PARTS REQUIRED

- FRONT PANEL (7)

At this stage it is important to determine on which side you wish to hang the doors from. If you require the doors to be fitted on the RH side of the unit then fit the front panel on the LH side (as shown). If you wish to fit the doors on the LH side of the unit then fit the front panel to the RH side of the unit.

8X



Position front part '7' as shown (at desired side of unit!). Screw to side and base panel.

STEP 2

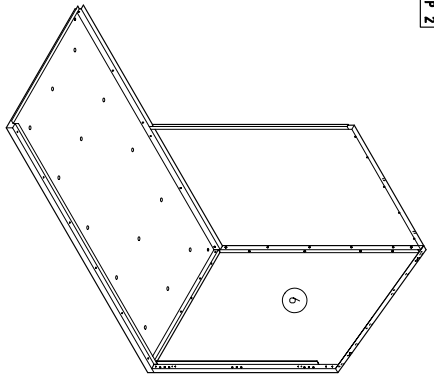

PARTS REQUIRED

- RH SIDE PANEL (6)

Position the RH side panel '6' into the channel on the base panel, and up to the already fixed RH back panel ensuring the fixing holes are all aligned screw together.

19X



STEP 6

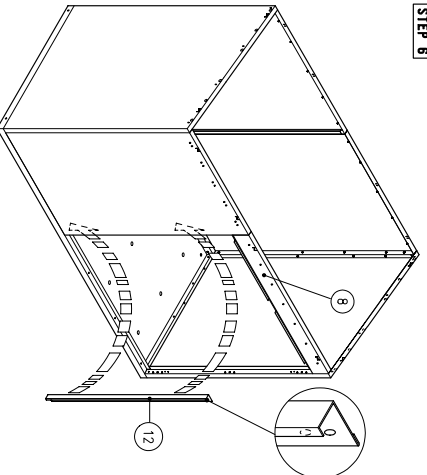

PARTS REQUIRED

- FASCIA (8)
- FRONT TRAP PLATE (12)

Attach fascia panel '8' across the front of the unit as shown, screw to front panel and side panel (requires 8 screws). From inside the unit attach the front trap plate '12' down the full length of the front panel. (requires 7 screws)

15X



STEP 3

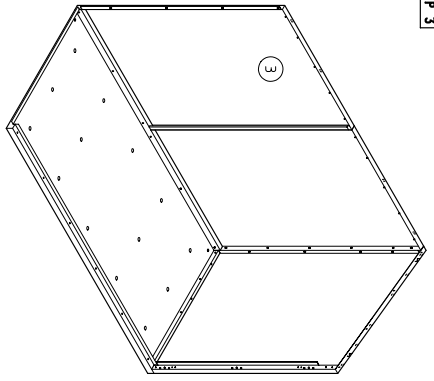

PARTS REQUIRED

- LH BACK PANEL (3)

Locate LH back panel '3' into base and LH back panel as shown. Screw together down full length of vertical joint and across the base.

16X



STEP 7

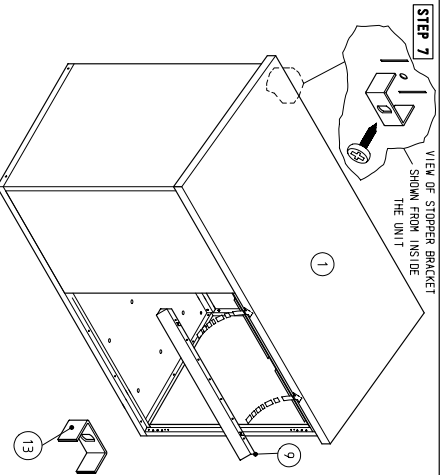

PARTS REQUIRED

- TOP PANEL (1)
- RAIN GUARD (9)
- STOPPER BRACKET (13)

Lift top panel '1' onto unit, over the outer panels and fascia, ensuring that the Asgard Stropoguard badge is on the front RH side and the ventilation holes are at the back. Slide the rainguard '9' under the top panel, over the fascia, centralise it, and screw through the fascia and into the top (from inside the unit). Having positioned the top and fitted the fascia, fit the stopper brackets '13' to the inside of the unit, these brackets locate into the pairs of slots on the top of each of the panels with the tabs on them pointing outwards (there are each fixed with a single screw, finally fit the remaining top panel screws).

41X



STEP 4

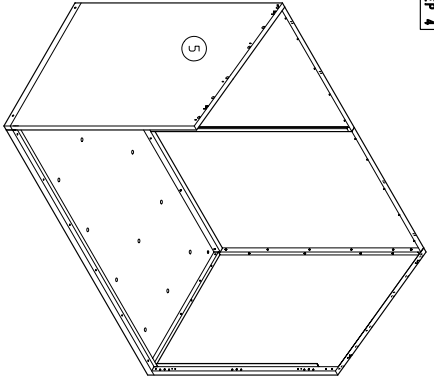

PARTS REQUIRED

- LH SIDE PANEL (5)

Position LH side '5' to LH back panel and base as indicated, ensuring the holes are all aligned screw together.

18X



STEP 8

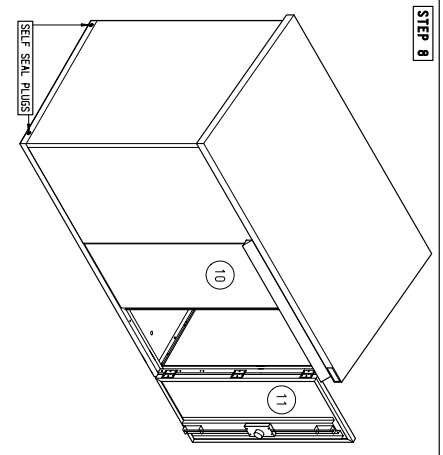

PARTS REQUIRED

- RH DOOR (10)
- LH DOOR (11)
- SELF SEAL PLUGS

WE ADVISE THAT YOU USE HAND HELD DRIVERS RATHER THAN POWER DRIVERS WHEN FIXING THE DOORS. IT IS IMPORTANT TO SUPPORT THE DOORS AT ALL TIMES whilst fitting the screws to ensure correct alignment. Position LH door '10' (non locking door) so that hinges are aligned with fixing holes so that hinges are aligned with fixing holes Position RH door '11' (locking door) so that hinges are aligned with fixing holes, screw in position. FIT FOUR SELF SEAL PLUGS INTO THE HOLES IN THE SIDES OF THE BASE PANEL TO PREVENT WATER INGRESS.

4X

