

BERMUDA



Pond Skimmer

Instruction Manual

IMPORTANT: Please read this instruction manual carefully before using this product. Keep the manual safe for future reference.

Thank you for purchasing a Bermuda Pond Skimmer. To ensure that this product is safely and correctly used, and at its optimal performance, please read this instruction booklet carefully before use.

Attention

1. Keep out reach of children
2. A drip loop should be installed in the power cable to ensure that water cannot travel down it, and into an electrical socket. Ensure the power cable and plug are higher than the water level in the skimmer.
3. An RCD, (of which the rated working current is not over 30mA) must be installed when using the skimmer / pump, and the power sockets must be connected to an Earth.
4. The pump included inside the Bermuda Pond Skimmer is designed for outdoor, underwater use only. Do not run the pump dry.
5. Do not use this pond skimmer when there is a lot of solid sludge in the pond, or when water temperature is higher than 40°C.
6. Always disconnect the power supply when handling, servicing or maintaining the skimmer / pump.
7. Do not attempt to unplug or unwire the skimmer / pump with wet hands.
8. Do not carry or retrieve the skimmer / pump by the electrical cables.
9. Power cables to the skimmer / pump cannot be replaced. If damaged or cut too short, discard the unit. Do not attempt to access the electricals inside.
10. The depth of water in the pond must be higher than the pond skimmer, do not use this pond skimmer when the water level is too low.
11. Only use in pond water, do not use in any any other liquid or chemicals.

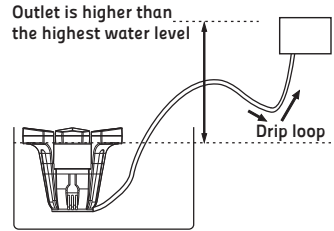

Features

- Compact, floating pond surface skimmer
- Automatically collects and filters debris
- Ideal for removing leaves and uneaten food from surface of pond
- Built-in 3,000 lph pump
- Easy to clean and remove skimmer basket

Usage

Only suitable for outside in garden ponds.

1. Install the floating body on the skimmer and check if all components are well installed. PLEASE NOTE that the filter cup and adjustable ring are removable.
2. Connect the power cable to an RCD power socket as referenced on page 2.
3. Ensure a drip loop is installed on the cable as referenced on page 2.
4. The skimmer should be placed in the pond, in an area where it can float and the water level is deep enough. You can leave the skimmer to float freely, or tie it up to secure its position.
5. When the skimmer is floating, the regulating ring will automatically adjust the height of the skimmer once the power is switched on. The top edge of the skimmer will be lower than the water level and the debris such as leaves will be drawn into the skimmer basket.
6. Remove and clear the skimmer basket regularly. ALWAYS disconnect from the mains supply before touching the skimmer / pump.
7. If the skimmer is not being used for a long period of time, disconnect it and keep it stored in a dry environment.

Trouble shooting

1. If the skimmer / pump are not working, unplug and check the power connections. Consult a qualified electrician for advice on electrical connections.
2. Inspect the power cable for signs of damage. If it is damaged it cannot be repaired or replaced. Do not use the product and dispose of responsibly.
3. If the adjustment ring is too low or too high, check if there is dirt on the ring or on the body. This will affect the performance of the skimmer. Unplug the skimmer and clean immediately.
4. If debris is overflowing or not collecting in the skimmer, it is likely the skimmer basket is full and needs emptying and cleaning.

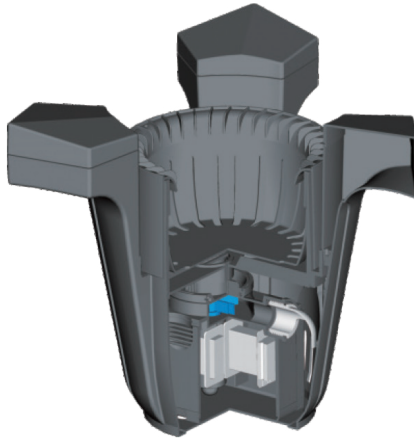

Specifications

MODEL	BER CODE	VOLTAGE	FREQUENCY	POWER	MAX. PUMP FLOW
Pond Skimmer	BER0150	230V	50/60Hz	43W	3000 LPH

Exploded view

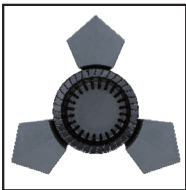
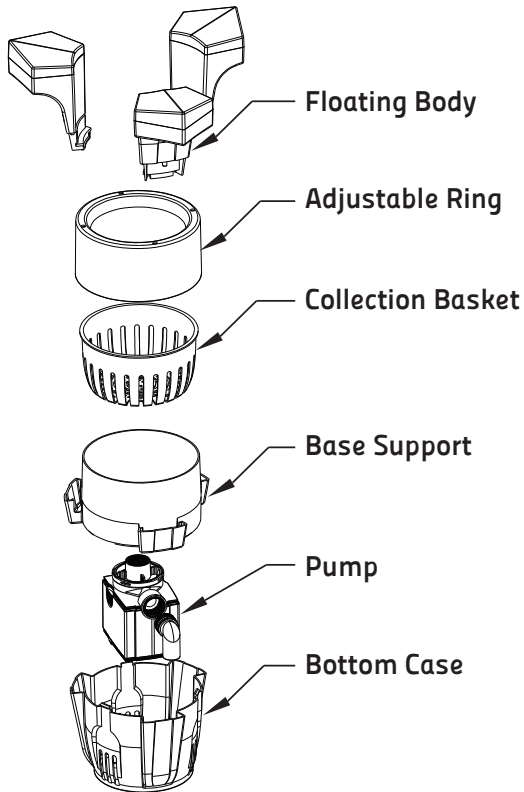

Guarantee

This product is guaranteed against defects in material and workmanship for **one year** from the date of purchase, under normal usage.

The guarantee **DOES NOT APPLY** in case of improper use, negligence, lack of maintenance or accidental damage to the pump. If the pump fails due to a manufacturing fault within this period it will be either repaired or replaced free of charge. Moving parts or wearable parts including the impeller and any washers are not covered by the guarantee.

Should your Bermuda product stop working refer first to trouble shooting and if this does not help, return the product to the place of purchase.

Liability is limited to replacement of the faulty product only. No other costs will be reimbursed. This guarantee is not transferable and does not affect your statutory rights.

Do not attempt to tamper with or access electrical components inside the pump body. Doing so will invalidate the warranty.

The manufacturer or supplier shall not be responsible, or held liable for any damages caused by defective components or materials of this product, or for loss incurred by interruption of service, or any consequential/incidental damages and expenses arising from the production, sale use or misuse of this product or any other consequential loss.

Any warranty claim must be accompanied by a valid, dated proof of purchase. Evolution Aqua, Bermuda, its distributors and dealers shall not be held liable for any loss of fish, plants or any other livestock as a result of any failure or defect of this product.

The installation and use of your product outside of our recommendations as printed in this manual may also void the warranty.



www.bermudawatergardens.com

BERMUDA an Evolution Aqua brand.
Evolution House, Kellet Close, Wigan, Lancashire, WN5 0LP

DISTRIBUTED BY: Certikin, Witan Park, Avenue 2,
Station Lane Industrial Estate, Witney, Oxfordshire, UK, OX28 4FJ